

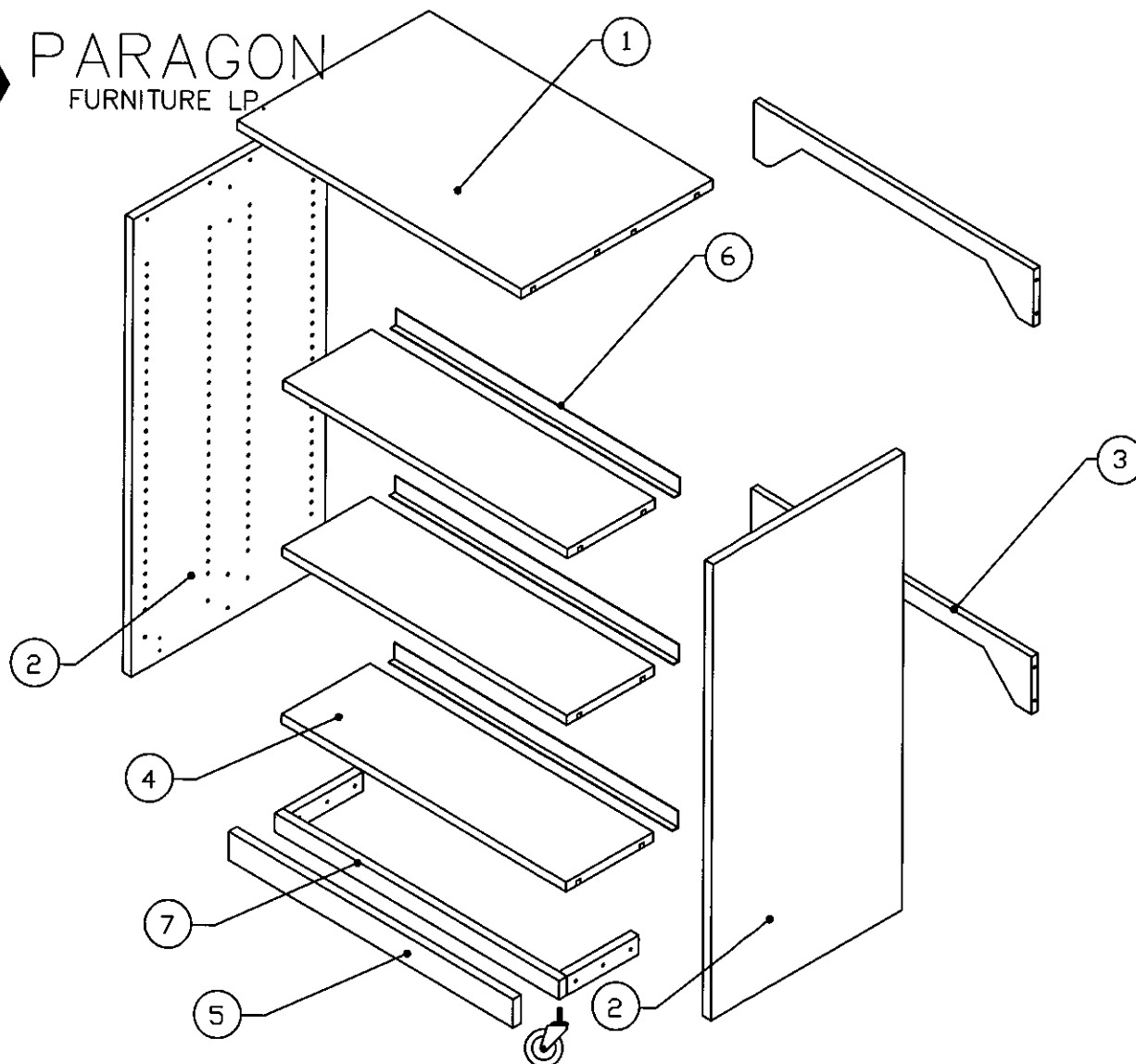

PARAGON
FURNITURE LP.

PAGE 1



MOBILE SHELVING

STEEL SHELVING

ASSEMBLY INSTRUCTION FOR 42-M-DFSM, 48-M-DFSM

ITEM	DESCRIPTION	9001058	9001058
		42-M-DFSM	48-M-DFSM
1	TOP	1	1
2	END PANEL	2	2
3	UNITIZER BRACES	2	2
4	WOOD SHELVES	2	2
5	ACCENT BASE	2	2
6	DEFLECTASTOP	6	6
7	METAL BASE FRAME (FOR CASTERS)	2	2
8	STEEL SHELVES	4	4

HARDWARE LIST

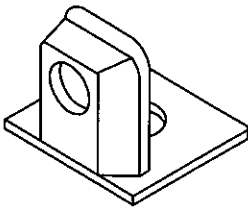

SCREW-IN TOP AND
BOTTOM CONNECTOR
(1010582)

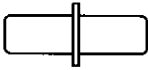

STEEL SHELF PIN
(10105881)

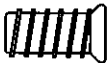

1/4" x 1/2"
ATTACHING SCREW
(1010585)



#8 x 3/4" FLAT
HEAD SCREW
(1010589)

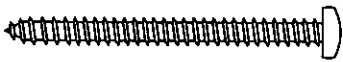

#8 x 1 3/4" PAN
HEAD SCREW
(10105744)

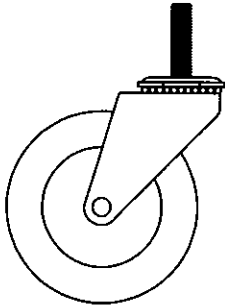

4" CASTER WITH BRAKE
4" CASTER WITH OUT BRAKE
(HRC-4)

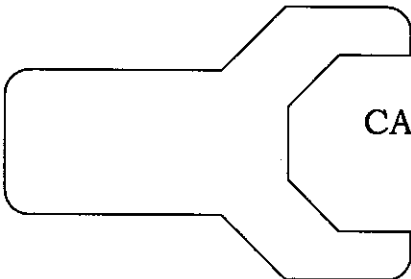

CASTER WRENCH
(1010965)

<u>QTY</u>	
42-M-DFSM	48-M-DFSM
16	16
16	16
28	28
8	8
20	20
2	2
2	2
1	1

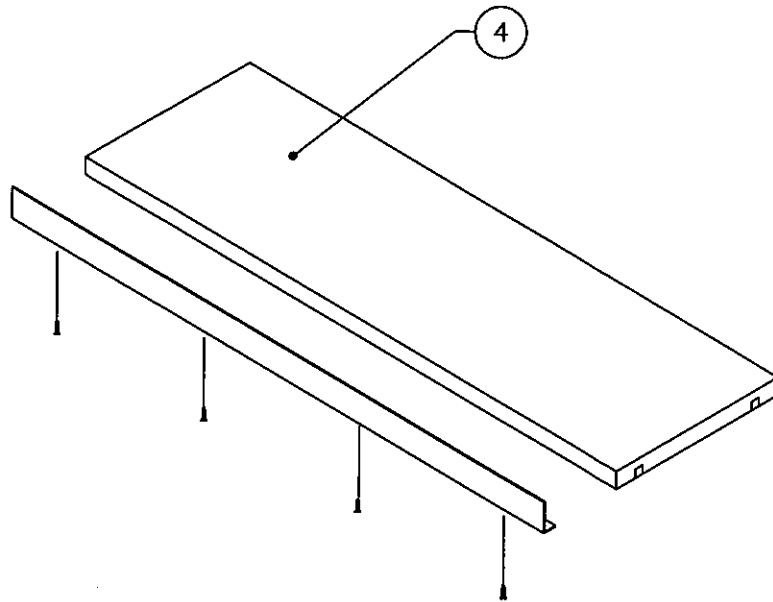
STEP 1

USING #8 X 3/4" FLAT HEAD SCREWS ASSEMBLE DEFLECTASTOP TO ALL WOOD SHELVES (ITEM 4).

USING #8 X 3/8" PAN HEAD SCREWS ASSEMBLE DEFLECTASTOP TO ALL STEEL SHELVES (ITEM 4) NOTE: ON SOME OF THE STEEL SHELVES THE DEFLECTA STOPS ARE BUILT ONTO THE SHELF.

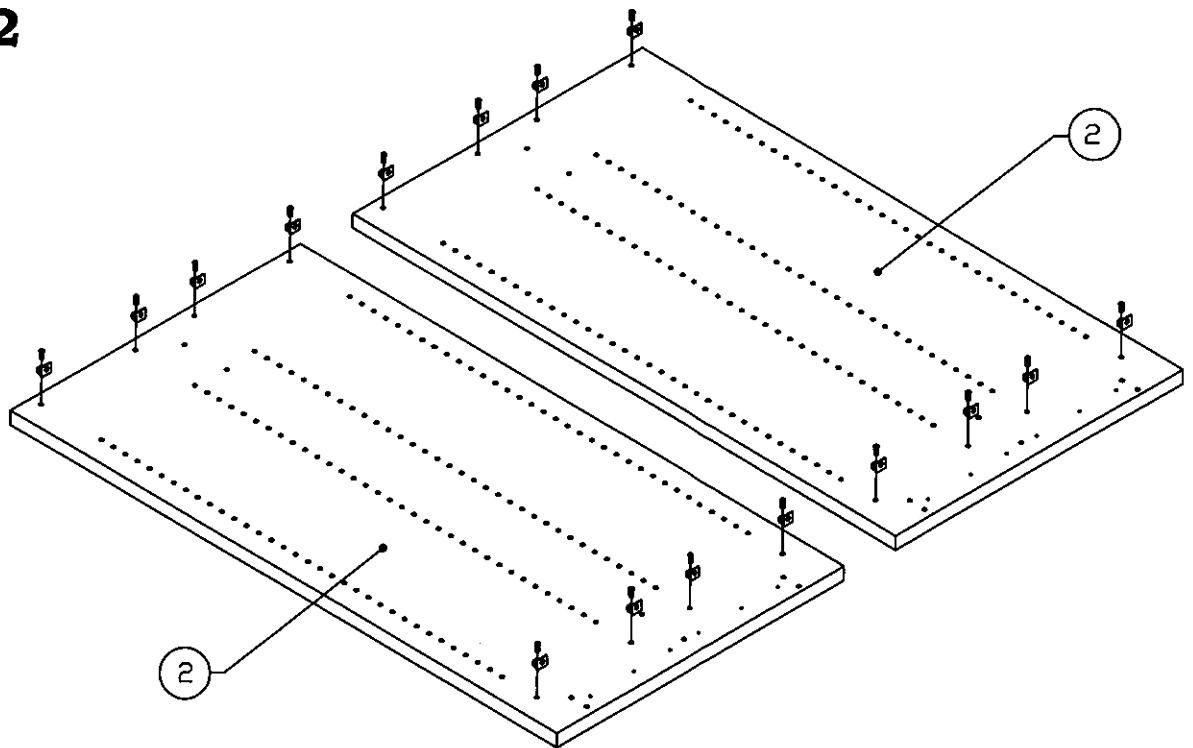
STEP 2

LAY END PANELS ON A CLEAN SCRATCH FREE SURFACE AND INSTALL THE SCREW-IN CONNECTORS USING 1/4" X 1/2" ATTACHING SCREWS

STEP 3

PAGE 4

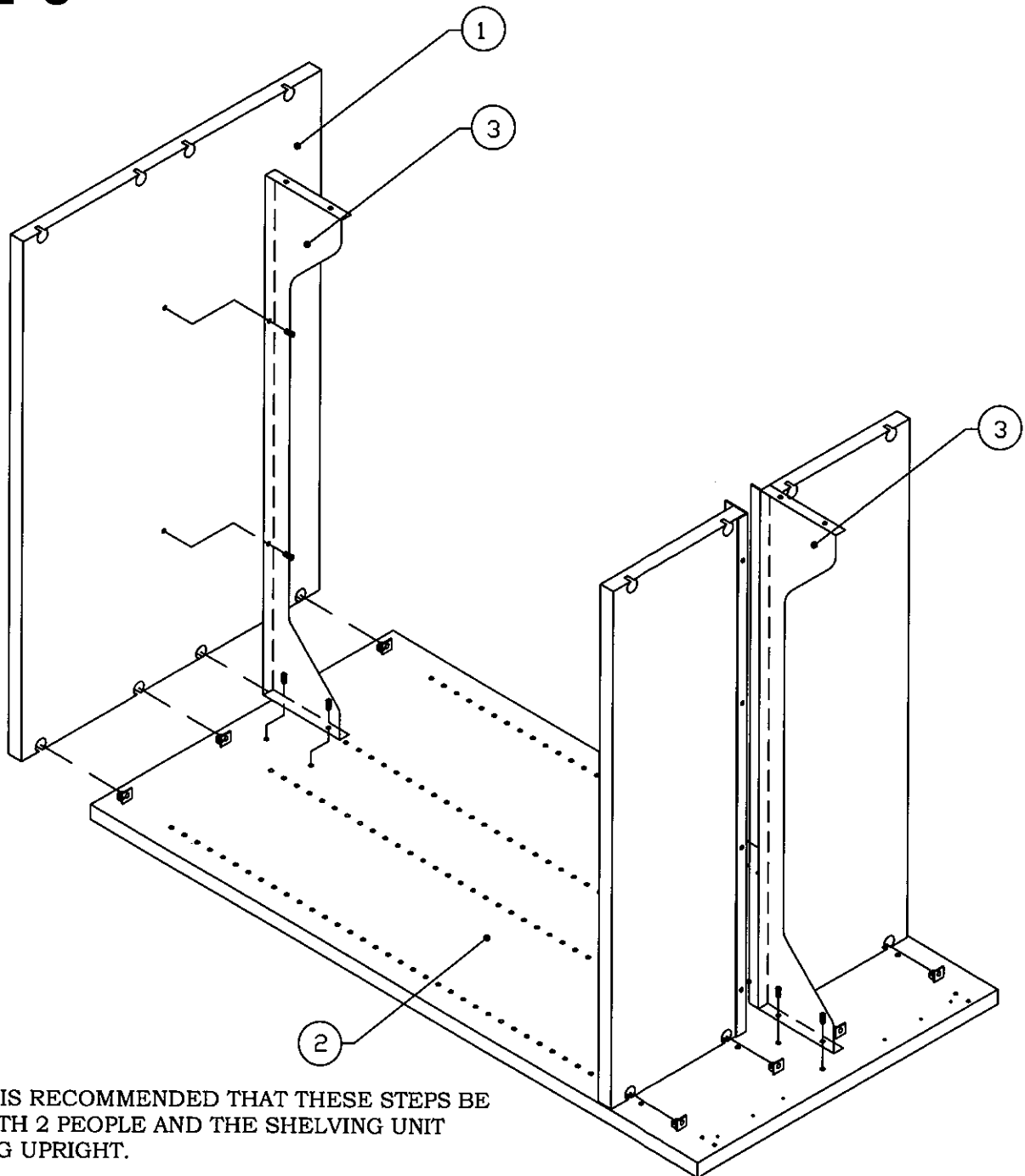

NOTE: IT IS RECOMMENDED THAT THESE STEPS BE DONE WITH 2 PEOPLE AND THE SHELVING UNIT STANDING UPRIGHT.

INSTALL UNITIZER BRACES (ITEM 3) WITH 1/4" X 1/2" ATTACHING SCREWS

NEXT INSTALL TOP (ITEM 1), AND BOTTOM SHELVES (ITEM 4) BY TAPPING ONTO THE CONNECTORS AND LOCKING THEM INTO PLACE BY TURNING SCREW IN CONNECTORS 1/2 TURN CLOCKWISE.

STEP 4

PAGE 5

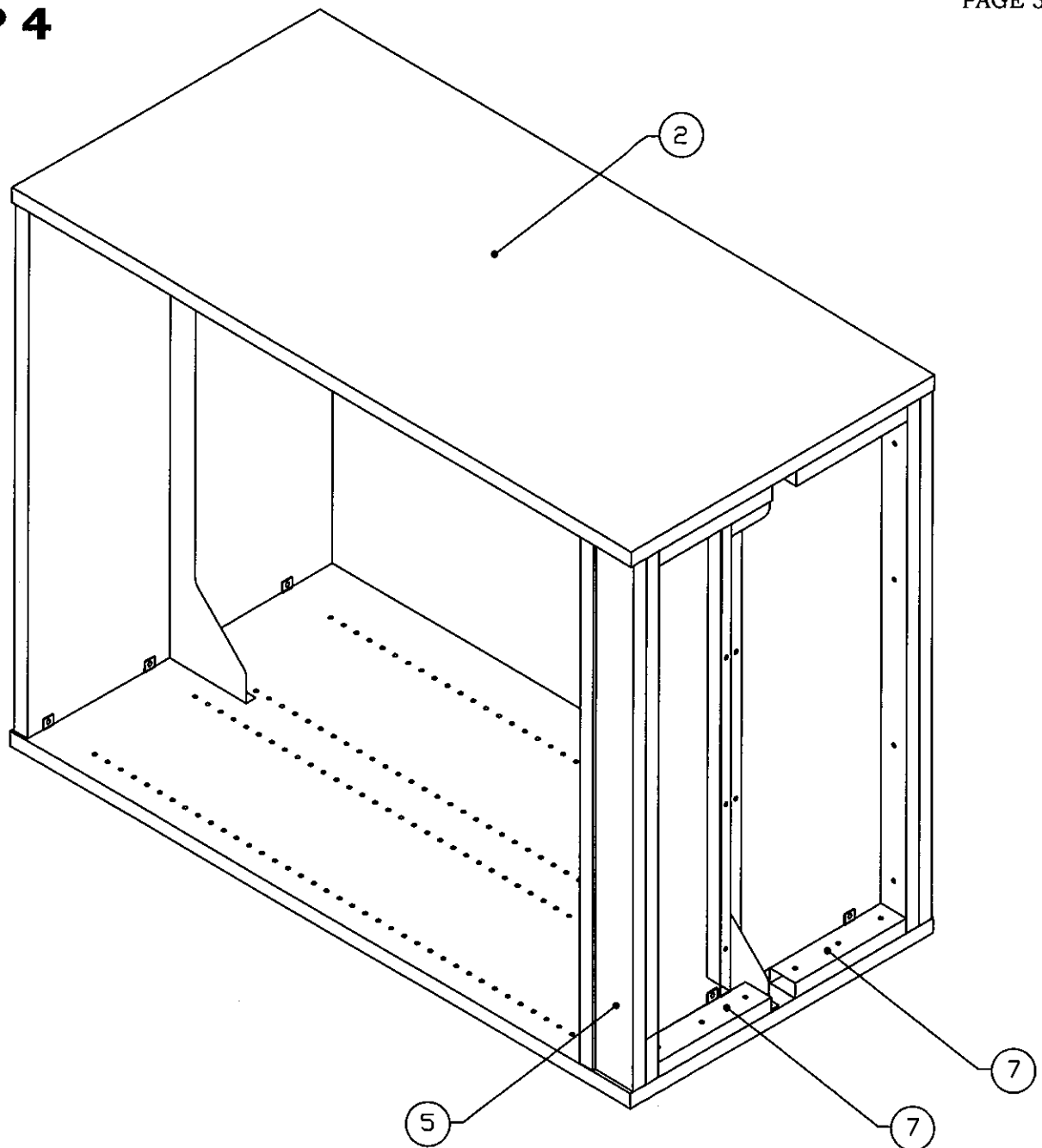

INSTALL RIGHT END (ITEM 2) WITH THE SAME METHODS USED TO INSTALL LEFT END.

TURN SHELVING UNIT UPSIDE DOWN BE SURE YOU HAVE LOCKED IN ALL OF THE CONNECTORS TO PREVENT THE SHELVES FROM FALLING OUT.

INSTALL THE 2 METAL BASE FRAMES (ITEM 7) USING #8 X 1 3/4" PAN HEAD SCREWS. SCREW BASE INTO END PANELS FIRST THEN PLACE ACCENT BASE IN FRONT OF FRAME AND SCREW IT ON (NOTE THE BASES ARE NOT PRE-DRILLED).

INSTALL CASTERS TIGHTEN WITH WRENCH PROVIDED
TURN SHELVING UNIT UPRIGHT AND INSTALL SHELVES.

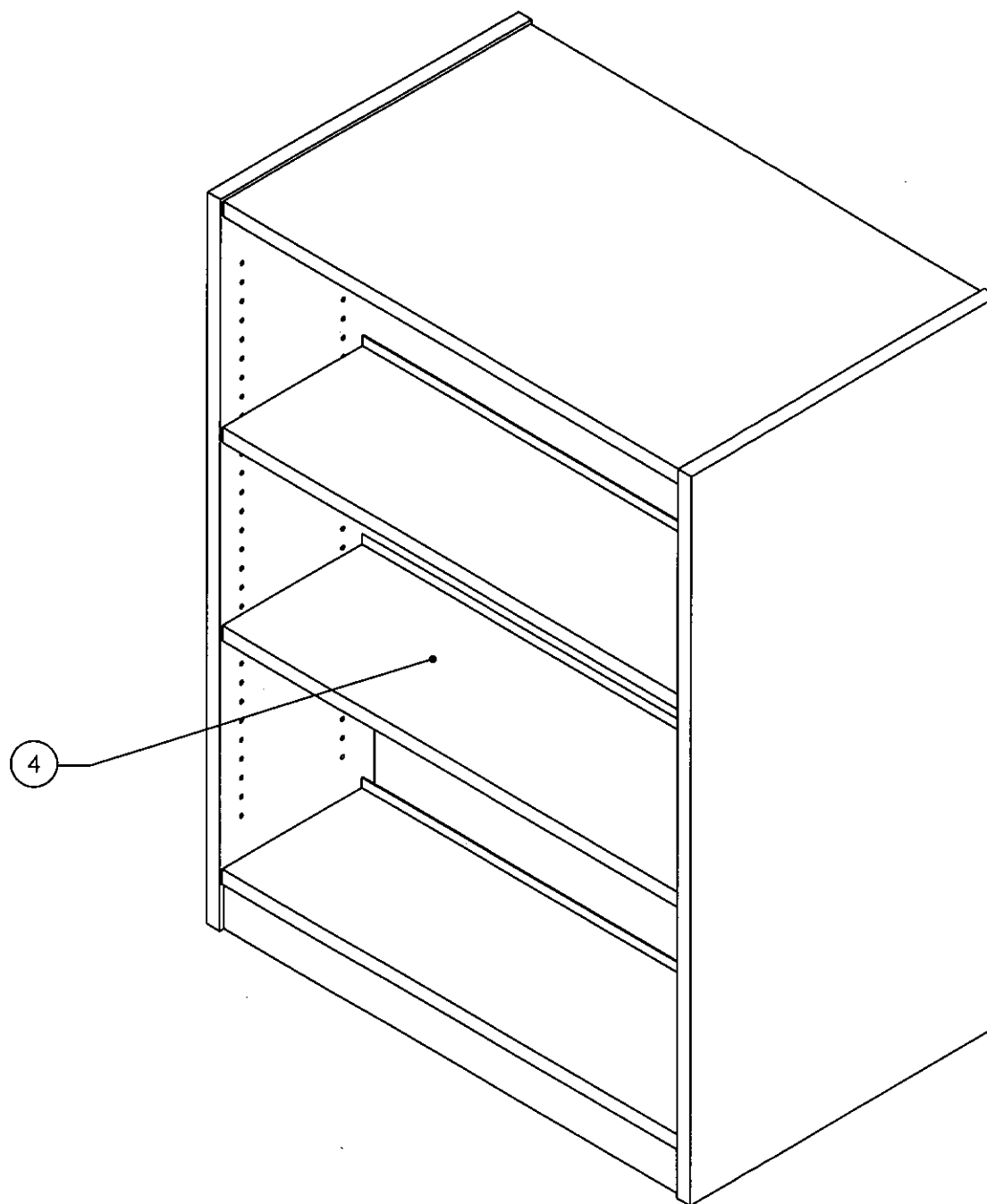

INSTALL SHELVES IN DESIRED LOCATION AND LOCK INTO PLACE

RECOMMENDED SHELF SPACING FROM THE BOTTOM UP

42-M-DFSM PIN IN THE 9 AND 19 HOLES

48-M-DFSM PIN IN THE 10 AND 22 HOLES

**NOTE: WE RECOMMEND INSTALLING
ALL THE SHELF PINS BEFORE
THE SHELVES**

**SHOULD YOU NEED ASSISTANCE CALL YOUR DEALER OR PARAGON AT
1-800-451-8546**

CONNECTORS

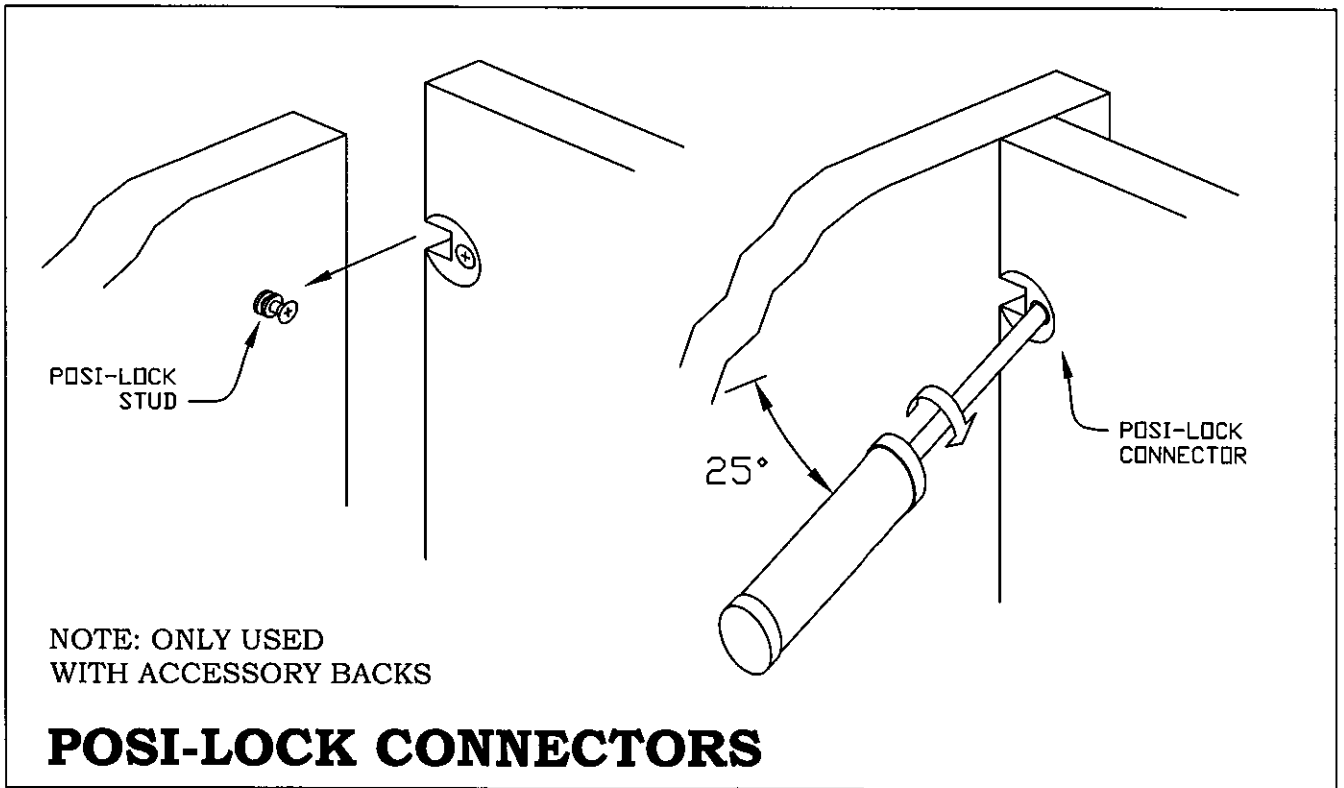
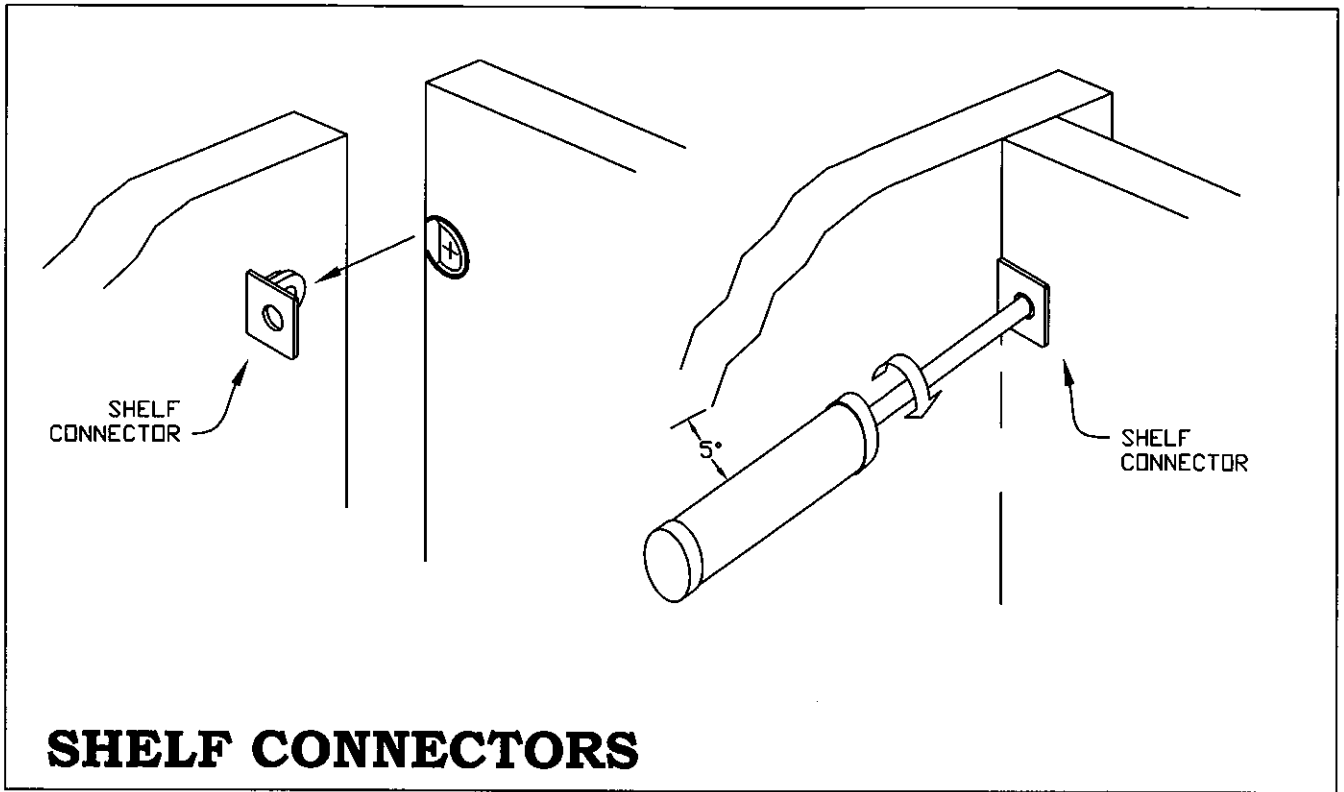

ASSEMBLY INSTRUCTION FOR METAL SHELVING

INSTALL DEFLECTASTOP SEE STEP 1 ON PAGE 3. INSTALL METAL SHELVES
USE PUSH IN PINS AND PLACE THEM IN THE DESIRED LOCATIONS NOTE THAT
ON THE 60", 72" AND 84" HIGH SHELVING THE CENTER SHELF NEED TO BE
SCREWED IN USING 1/4" X 1/2" ATTACHING SCREWS.

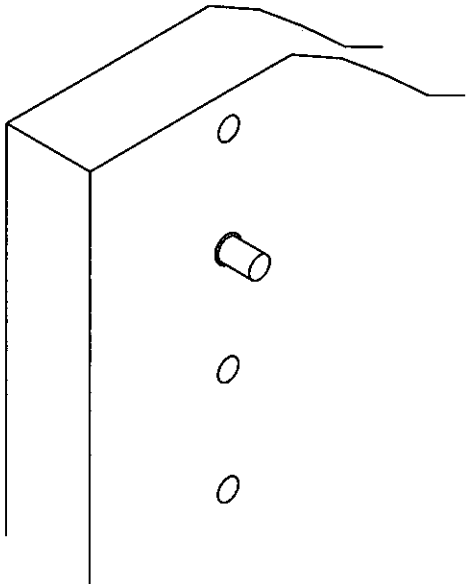

ITEM	DESCRIPTION	QTY.				
		42-DFS	48-DFS	60-DFS	72-DFS	84-DFS
1	ADJUSTABLE SHELF PINS	16	16	24	32	40





NOTE: THE SHELVING
ACCESSORY BACK
REPLACES THE
UNITIZER BRACES.

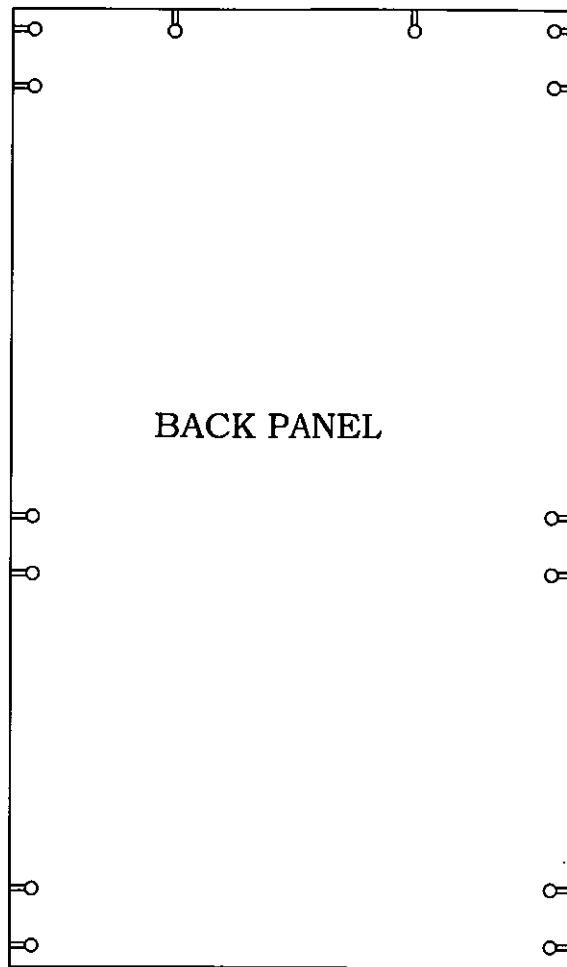

ASSEMBLY INSTRUCTION FOR ACCESSORY BACK 42-AB, 48-AB, 60-AB, 72-AB, 84-AB

ITEM	DESCRIPTION
1	BACK PANEL

HARDWARE

	CAM SCREW	QTY.				
		42-AB	48-AB	60-AB	72-AB	84-AB
		10	10	14	14	14

1. INSTALL CAM SCREWS INTO HOLES ALONG BACK EDGES OF SHELVING END PANELS AND SHELVING TOP SCREW INTO PANEL UNTIL SHOULDER REST ON SURFACE OF PANEL (CENTER ON DOUBLE FACED UNITS).
2. TO ASSEMBLE SHELVING UNIT HOLD END PANEL IN UPRIGHT POSITION SLIDE BACK PANEL ONTO CAM SCREWS AND LOCK INTO PLACE BY TURNING THE CAM CLOCKWISE 210 DEGREES.
3. REPEAT STEP 2 WITH THE OTHER END PANEL
4. PUSH BOTTOM SHELF ONTO CONNECTORS AND LOCK INTO PLACE BY TURNING THE SCREW IN CONNECTORS 1/2 TURN CLOCKWISE. (NOTE: YOU WILL NEED A SHORT STUBBY PHILLIPS SCREWDRIVER TO DO THIS).
5. INSTALL BASE WITH EDGE BANDED EDGE DOWN TOWARD THE FLOOR JUST LINE IT UP AND GIVE IT A FIRM PUSH ONTO THE CONNECTORS.
6. INSTALL TOP PUSH DOWN ONTO CONNECTORS AND LOCK INTO PLACE.
7. INSTALL THE REST OF THE SHELVES IN THE DESIRED LOCATION.