



## INFINITY CIRCULATION DESK

Classic wood style design brings warmth to any space. Create a circulation desk with a variety of components that fit together seamlessly from work centers to corner units to book returns.



## FEATURES

Paragon Infinity Circulation Desks are designed & manufactured specifically for educational environments. They are flexible, functional, durable, & look great too!

### COMPONENTS

Infinity Circulation Desk is made up of:

- Desk Shell
- Desk Shell With Transaction Shelf
- Two Drawer Unit
- ADA Unit
- Corner Display
- Closed Corner Unit
- Working Corner
- Hinged Door Unit
- Open Storage
- Book Return
- Depressible Book Cart

### SURFACE

1 1/4" High Pressure Laminate (HPL) top.

### FRAME

Thermally Fused Melamine (TFM) sides & back with matching 3 mm PVC edge banding.

### FEATURES

Cable Wire Management. Grommets & wire management channel.



## CONFIGURING A MODEL NUMBER

The Infinity Circulation Desk consists of several different components that work together to create a workstation that is configured to your specifications. Each piece is configured separately & in this example, we start with the desk shell using model number **3260-DS-29** & the model number can be broken up with parenthesis like this:

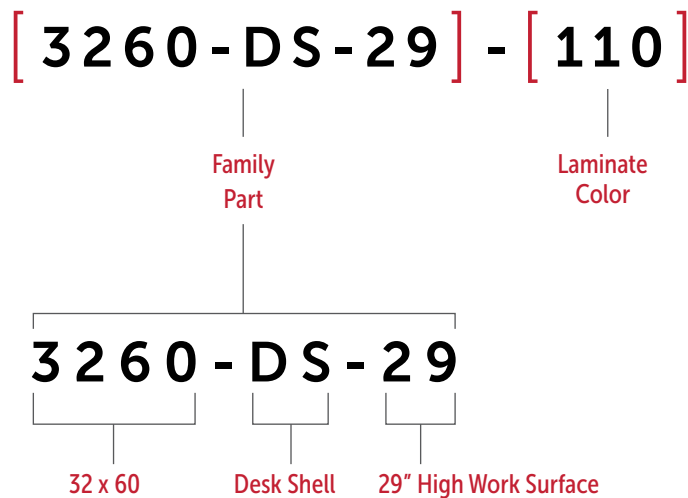

## COLOR &amp; FINISH OPTIONS

STEP 1  
LAMINATE  
COLOR

Top, front, back, sides, & edge are all finished in the same laminate color. Specify one of the laminates below by using the number next to the laminate name.

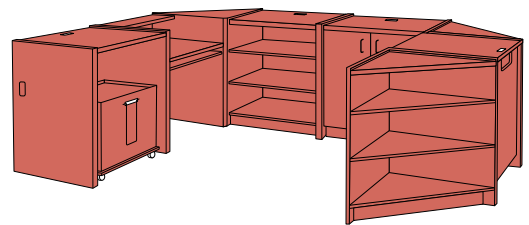

[ FAMILY PART ] - [ LAMINATE COLOR ]

## LAMINATE

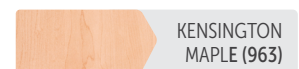
XANADU  
(110)STUDIO  
TEAK (103)RIVER  
CHERRY (566)KENSINGTON  
MAPLE (963)

## MODEL NUMBERS & PRODUCT SPECS

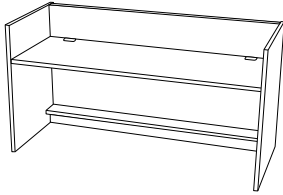

### DESK SHELL

Model #	Width (in)	Depth (in)	Height (in)	Weight (lbs)	Freight Class (Qty 1)
3236-DS-29	36	30	32	175	85
3236-DS-32	36	30	32	175	85
3248-DS-29	48	30	32	220	85
3248-DS-32	48	30	32	220	85
3260-DS-29	60	30	32	250	85
3260-DS-32	60	30	32	250	85
3272-DS-29	72	30	32	270	85
3272-DS-32	72	30	32	270	85
3936-DS-29	36	30	39	195	85
3936-DS-32	36	30	39	195	85
3948-DS-29	48	30	39	230	85
3948-DS-32	48	30	39	230	85
3960-DS-29	60	30	39	265	85
3960-DS-32	60	30	39	265	85
3972-DS-29	72	30	39	300	85
3972-DS-32	72	30	39	300	85

-29 & -32 Indicate the work surface height. -29 Includes a privacy panel & -32 does not

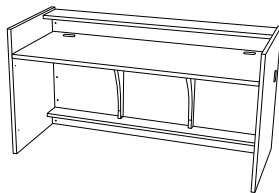

### TRANSACTION DESK SHELL

Model #	Width (in)	Depth (in)	Height (in)	Weight (lbs)	Freight Class (Qty 1)
3936-TDS-29	36	30	39	215	85
3936-TDS-32	36	30	39	215	85
3948-TDS-29	48	30	39	250	85
3948-TDS-32	48	30	39	250	85
3960-TDS-29	60	30	39	295	85
3960-TDS-32	60	30	39	295	85
3972-TDS-29	72	30	39	330	85
3972-TDS-32	72	30	39	330	85

-29 & -32 Indicate the work surface height

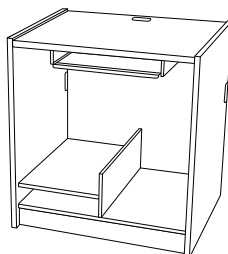

### COMPUTER WORK STATION

Model #	Width (in)	Depth (in)	Height (in)	Weight (lbs)	Freight Class (Qty 1)
32-CWS	36	30	32	220	85
39-CWS	36	30	39	240	85

## TWO DRAWER UNIT

Model #	Width (in)	Depth (in)	Height (in)	Weight (lbs)	Freight Class (Qty 1)
32-2D (1 Adjustable Shelf)	36	30	32	250	125
39-2D (1 Adjustable Shelf)	36	30	39	270	125

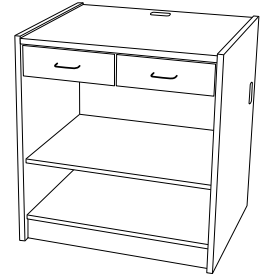

## ADA UNIT

Model #	Width (in)	Depth (in)	Height (in)	Weight (lbs)	Freight Class (Qty 1)
32-ADA	36	30	32	130	85

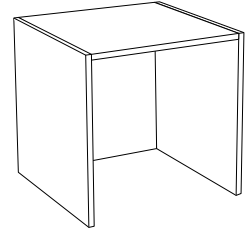

## CORNER DISPLAY

Model #	Width (in)	Depth (in)	Height (in)	Weight (lbs)	Freight Class (Qty 1)
32-CD (1 Adjustable Shelf)	42	22	32	140	85
39-CD (2 Adjustable Shelves)	42	22	39	165	85

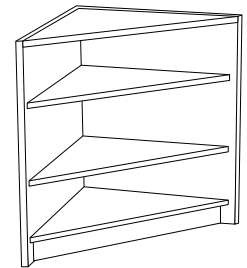

## CLOSED CORNER UNIT

Model #	Width (in)	Depth (in)	Height (in)	Weight (lbs)	Freight Class (Qty 1)
32-CC	42	22	32	155	150
39-CC	42	22	39	175	150

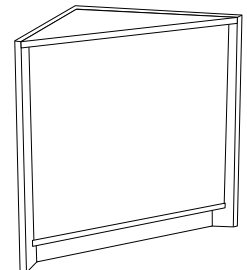

## WORKING CORNER

Model #	Width (in)	Depth (in)	Height (in)	Weight (lbs)	Freight Class (Qty 1)
32-WC	66	36	32	250	85
39-WC	66	36	39	270	85

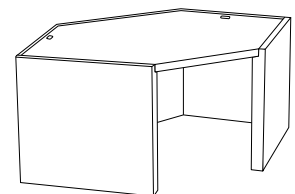

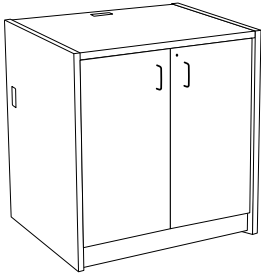

## HINGED DOOR UNIT

Model #	Width (in)	Depth (in)	Height (in)	Weight (lbs)	Freight Class (Qty 1)
32-HD (1 Adjustable Shelf)	36	30	32	240	85
39-HD (2 Adjustable Shelves)	36	30	39	265	85

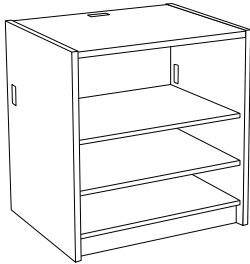

## OPEN STORAGE

Model #	Width (in)	Depth (in)	Height (in)	Weight (lbs)	Freight Class (Qty 1)
32-OS (1 Adjustable Shelf)	36	30	32	215	85
39-OS (2 Adjustable Shelves)	36	30	39	255	85

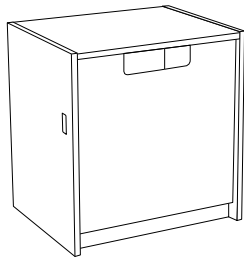

## BOOK RETURN

Model #	Width (in)	Depth (in)	Height (in)	Weight (lbs)	Freight Class (Qty 1)
32-BR	36	30	32	175	85
39-BR	36	30	39	195	85

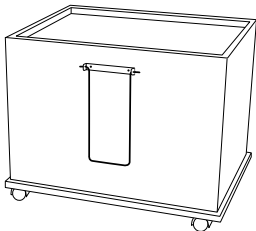

## DEPRESSIBLE BOOK CART

Model #	Width (in)	Depth (in)	Height (in)	Weight (lbs)	Freight Class (Qty 1)
DBC	29	21.5	24	100	125

Available in the following laminates: Kensington Maple, River Cherry, Studio Teak, Xanadu, Folkstone, Frost, Black

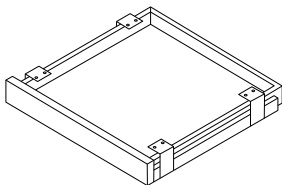

## PENCIL DRAWER ACCESSORY

Model #	Width (in)	Depth (in)	Height (in)	Weight (lbs)	Freight Class (Qty 1)
PDA	17.5	17	3	10	85